



BENDIGO LIBRARY

ACMEI WINDOWS AND DOORS ENSURE THE RENOVATED BENDIGO LIBRARY MAKES A DRAMATIC IMPACT ON LOCAL COMMUNITY.

The Bendigo Library was originally built in 1983. The complex had serviced the local community in its two storey structure for over 30 years and was a well-known complex within Bendigo.

The building had become dated and was poorly integrated with the adjoining car park and streets. The building required a renovation and upgrade to its facilities.

MGS Architects won the tender for the site's redevelopment, and started the project by working with the spatial elements they already had in the existing

building. The architects took visual cues from nearby buildings as well as the current site for design inspiration. MGS Architects were required to ensure the heritage of the building was somewhat maintained.

The redevelopment included ensuring the new site was enticing to the local community and enhanced the interplay of light throughout the building. The building was to be light filled and inspirational, with the aim of encouraging creativity and productivity in the community.

AWS | PROJECT FEATURE

Local aluminium window and door manufacturers ACMEI Windows and Doors were chosen to complete the extensive glazing for this project. ACMEI assisted MGS Architects and the builders to decide upon the perfect window and door system for this refurbishment.

The Elevate™ Aluminum Systems range of aluminum windows and doors was used for this project. The Elevate™ range is custom made, ensuring the architects received the perfect glazing solution for their unique design.

Series 626 Double Glazed, Front Glazed framing was used to frame the external glazing that surrounds the building. This commercial framing system incorporating double glazing has ensured minimal artificial heating and cooling in this extreme weather climate. Series 400 Single Glazed, Centre Glazed framing is used for internal glazed floor to ceiling windows and doors.



For more information & the full gallery, visit:
elevatealuminium.com.au

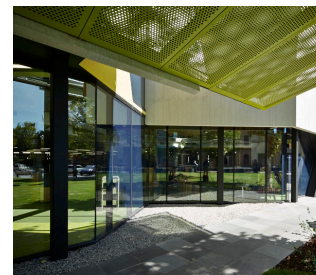

Architect: MGS Architects | Photography: Andrew Latreille

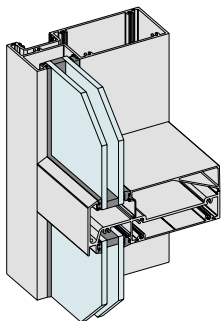

ELEVATE™ SERIES 626 DOUBLE GLAZED, FRONT GLAZED FRAMING

- × Double glazed FrontGLAZE™ framing system designed specifically to accept 24mm Insulating Glass Units (IGUs) with the required 12mm glass bite.
- × High water resistance can be achieved. Has been successfully tested at 600Pa water resistance.
- × The 150 x 60mm framing system has a variety of transom and mullion alternatives. This system will also accept many of the Series 606 FrontGLAZE™ frame accessories including doors, sub-frames and thresholds.
- × Alternative structurally glazed mullion.
- × Optional midrail will also accept 24mm IGUs.
- × Transoms have built-in drip groove to encourage water to leave the face of the framing.
- × Sills and transoms are splayed at 25° to reduce the chance of dust and pollution build-up.



AcmeI Windows & Doors have been supplying and installing aluminium windows and doors for over 20 years. With many years' experience and expertise in the aluminium window and door manufacturing industry, Stuart and Sharyn Healy have gained a reputation for providing quality products and a friendly, efficient service in Bendigo and it's surrounds.

2D & 3D CAD Files Available | Download from specifyaws.com.au to use in your projects.

For more information on this and the rest of the Elevate™ range: elevatealuminium.com.au

